

Plan of New Wardour Castle showing Changes in Use of Rooms

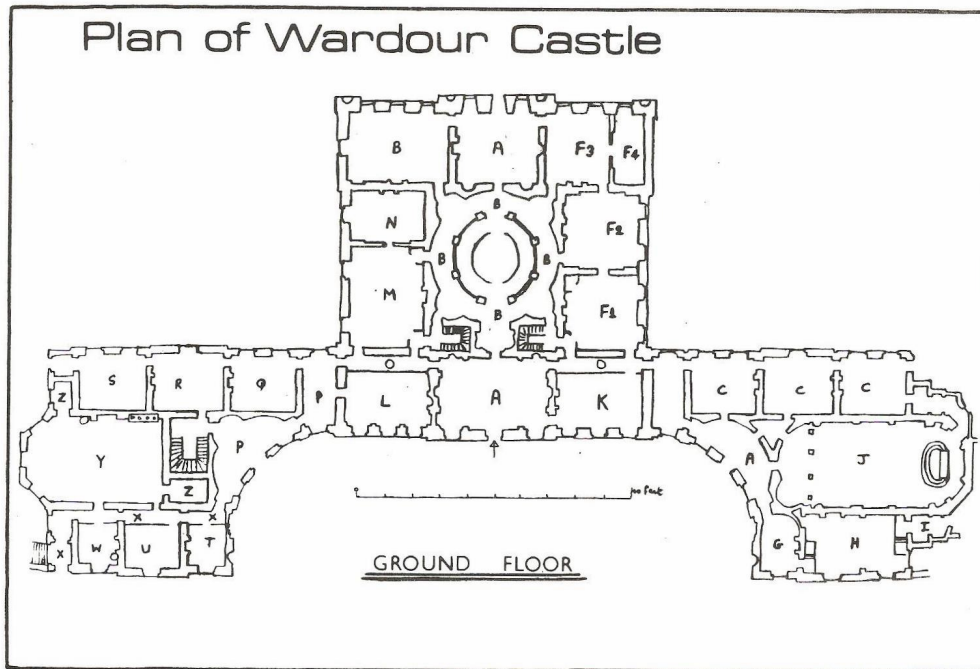

Changes in the Use of Rooms

<u>PAINES PLAN, 1776</u>	<u>AS USED IN 1935</u>	<u>PAINES PLAN, 1776</u>	<u>AS USED IN 1935</u>
A Hall	Hall	L Servants' Hall	Audit Room
B Grand Staircase	Grand Staircase	M Butler's Pantry	Butler's Pantry
C Chaplain's Apartments	Chaplain	N Plate Room	Plate Room
D South Hall	Dining Room	O Passages	Passages
E Common Dining Room	Nursery	P Entrance to East Wing	Entrance
F1 Agent's Room	Agent's Room	Q Steward's Dining Room	Dining Room
F2 " "	Muniment Room	R Housekeeper's Room	Still Room
F3 Steward's Room	Study	S " "	Pantry
F4 " "	Telephone Room	T Clerk of Kitchen's Room	Lavatory
G Laundry Maid's Room	Pantry	U Wet Larder	Larder
H Laundry	Kitchen	W Scullery	Larder
I Passage	Passage	X Passages	Passages
J Chapel	Chapel	Y Kitchen	Kitchen
K Audit Room	Kitchen	Z Dry Larder	Scullery

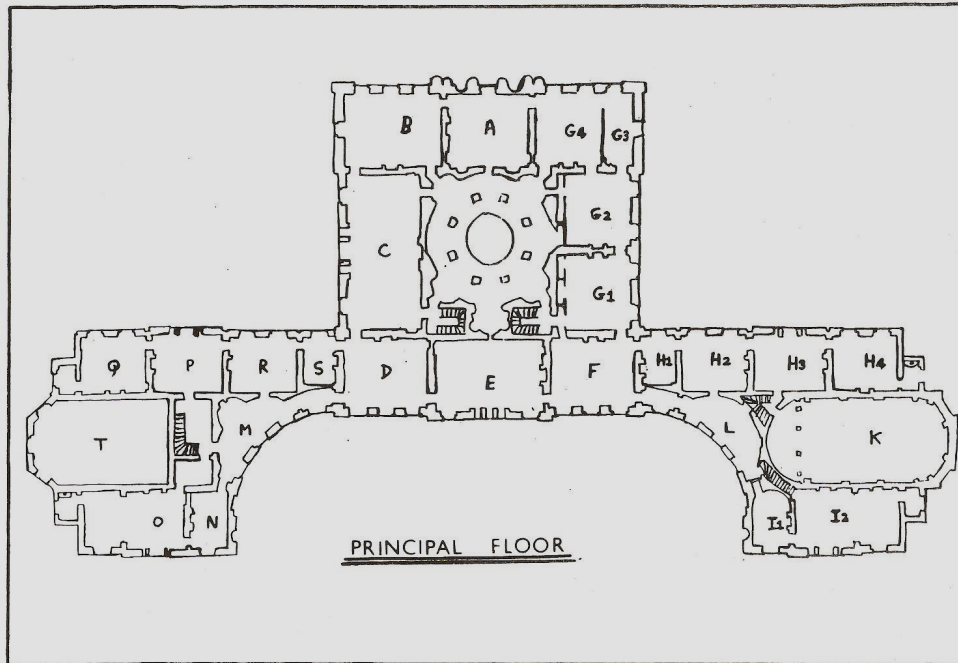

<u>PAINÉ'S PLAN, 1776</u>	<u>AS USED IN 1935</u>	<u>PAINÉ'S PLAN, 1776</u>	<u>AS USED IN 1935</u>
A Ante Chamber	Music Room	H4 Suite of Apartments	Lady Arundell's Bedroom
B Drawing Room	Drawing Room	I1 " "	Chintz Dressing Room
C Salon	Great Dining Room	I2 " "	Chintz Bedroom
D Common Dining Room	Blue Drawing Room	K Upper Chapel	Upper Chapel
E Great Dining Room	Saloon	L Ante Chamber	Gallery
F Library	Library	M Ante Chamber	Gallery
G1 Suite of Apartments	Boudoir	N Dressing Room	North Dressing Room
G2 " "	State Bedroom	O Bedchamber	North Bedroom
G3 " "	Lavatory	P Breakfast Room	Sitting Room
G4 " "	Little Drawing Room	Q His Lordship's Room	Bedroom
H1 Suite of Apartments	Bathroom	R Her Ladyship's Room	Buff Bedroom
H2 " "	Bedroom	S Book Room	Buff Dressing Room
H3 " "	Ante Room	T Upper Kitchen	Upper Kitchen

Above the rooms in the main block were six bedrooms and four dressing rooms; and above those, nineteen rooms in the attic for servants.